

AITIOU

A1606W

⊙ Amorphous Toroidal Core:(Common mode Choke)

⊙ Mechanical Properties:

Bare Core Dimensions (mm)			Finished Core Dimensions (mm)			Case Material & Color
O.D _{±0.2}	I.D _{±0.2}	H.T _{±0.2}	O.D _{±0.5}	I.D _{±0.5}	H.T _{±0.3}	
16.0	12.0	8.0	18.3	10.5	11.3	PBT or NYLON,White VS.White

⊙ Typical Parameters and Magnetic Properties:

Lm (mm)	Ac (mm ²)	Wa (mm ²)	WaAc (mm ⁴)	Vol (mm ³)	Bs@25°C (T)	μ _i 10KHz	A _L @10KHz (μ H)
43.96	12.80	86.55	1107.79	703.36	1.10	60000.00	23 MIN

⊙ Core Finished Material:

Insulating Covers:UL94V-0 or equivalent

⊙ Temperature Range:

Storage temperature-20 ~ +50°C Ambient Temperature

Operating Temperature -40 ~ +120°C Case Surface Temperature

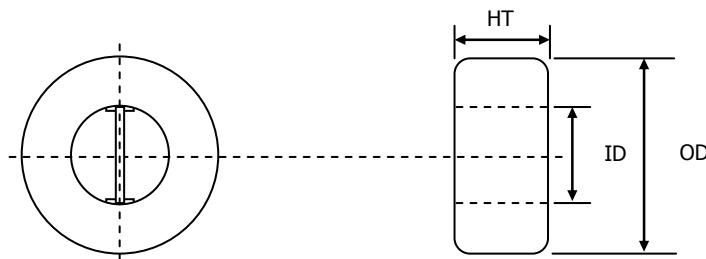

WIRE	1.0¢	TURNS	1Ts	TEMP.	25°C
------	------	-------	-----	-------	------

2 TEST INSTRUMENTS: ZENTECH 3302

The inductance attenuation curve

