

AITIOU

A2506W

⊙ Amorphous Toroidal Core:(Common mode Choke)

⊙ Mechanical Properties:

Bare Core Dimensions (mm)			Finished Core Dimensions (mm)			Case Material & Color
O.D ± 0.2	I.D ± 0.2	H.T ± 0.2	O.D ± 0.3	I.D ± 0.3	H.T ± 0.3	
25.0	15.0	10.0	30.0	12.7	16.9	PBT or NYLON,White VS.White

⊙ Typical Parameters and Magnetic Properties:

Lm (mm)	Ac (mm ²)	Wa (mm ²)	WaAc (mm ⁴)	Vol (mm ³)	Bs@25°C (T)	μ_i 10KHz	A _L @10KHz (μ H)
62.80	40.00	126.61	5064.51	3140.00	1.10	60000.00	48 MIN

⊙ Core Finished Material:

Insulating Covers:UL94V-0 or equivalent

⊙ Temperature Range:

Storage temperature-20 ~ +50°C Ambient Temperature

Operating Temperature -40 ~ +120°C Case Surface Temperature

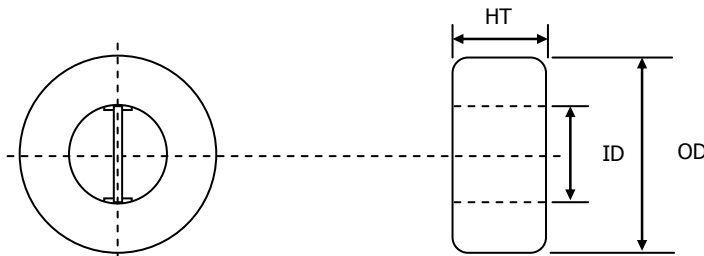

WIRE	1.0 ϕ	TURNS	1Ts	TEMP.	25°C
------	------------	-------	-----	-------	------

2 TEST INSTRUMENTS: ZENTECH 3302

The inductance attenuation curve

